

Public Services Committee Meeting May 22, 2013

The **Public Service Committee** met Wednesday, May 22, 2013, at 6:00 pm in the City Hall conference room. Present were Committee Chairperson Sue Galbraith and Committee Members Jerry Partridge, Dwayne Andrews and John Hollowell. Also present were Grant Administrator Dawn Colton and Committee Recorder/Deputy City Clerk Connie Watts.

Chairperson Galbraith called the meeting to order.

1. Request by Shanna Abbott for Fence Encroachment at 115 N. Winchester Avenue

Shanna Abbott, 115 N. Winchester Ave., presented her request for a fence encroachment on City property. She requested permission to put in a six-foot wide sidewalk at the curb, extending the full width of the front of her property. She mentioned that there are no other sidewalks on that block. She would then like to put in a fence at the sidewalk with the sides connecting to the existing fence in her backyard. A diagram of the property is attached to these minutes.

The Committee members cautioned Ms. Abbott to check with the Engineer's Office upstairs at City Hall to determine the exact requirements with which she needed to comply to install the fence. For example, a fence in the front yard can be no higher than three feet in the front of the property. After some additional discussion,

*** Committee Member Hollowell moved to recommend allowing the fence encroachment, contingent upon the homeowner complying with all the regulations from the Engineering Department and also contingent upon the installation of the six-foot sidewalk. The motion was seconded by Committee Member Partridge and, on roll call vote, passed unanimously, 4-0.*

2. Update on Montana Ave. Sidewalks/Milwaukee Railroad Crossing

Grant Administrator Colton updated the Committee on the above-mentioned sidewalks, which would be a CTEP project. This Committee had selected the Milwaukee project to be second priority. This project consists of replacing the sidewalk from Gordon to Ivy along North Montana Street, including repairing the crossing at the Milwaukee tracks. In addition, the project would construct a sidewalk from Lincoln Street to Bender Park. She included pictures of the site. Administrator Colton performed a review of the site, and now recommends dropping the portion of the project from Lincoln to Bender Park.

One side of the street would be very conducive to putting in a sidewalk. Then the sidewalk might have to switch to the other side of the street because of ditches on that side, and then would have to switch back. Both sides of the street encounter the Slough, which may

need to have a bridge constructed over it. She feels this stretch of sidewalk would be very problematic and, because of all the "fix" issues, would also become very expensive. It is, however, not in the flood-way. The sidewalk, alone, to Bender Park would be \$80,000.

Engineering is currently figured at 35% of the construction. If no right of way issues are encountered, those costs could drop to 25%. She has talked to Transisco to determine if there are permits required, but has not heard back from them yet.

There are two options to repairing the Milwaukee crossing. One is to place concrete blocks between the tracks as has been done on 10th Street. The other is to place wooden blocks between the tracks which, of course, deteriorate much faster than the concrete.

Discussion: Sidewalks/CTEP/Matching Committee Member Hollowell asked how the committee would feel about recommending to the Council that individuals whose properties fall within the CTEP project areas be required to pay the 13% match. All members of the Committee were in favor of considering this idea.

3. Request of Citizens

There were no requests of citizens.

ADJOURNMENT

** Having no further business, *Committee Member Andrews moved to adjourn the meeting, seconded by Committee Member Hollowell and passed unanimously, 4-0.*

The meeting was adjourned at 6:25 p.m.

Respectfully Submitted:

Susanna Galbraith, Chairperson

Connie L. Watts, Recorder

Shanna Abbott
115 N Winchester Ave
Miles City MT 59301
April 26, 2013

City of Miles City
17 South 8th Street
Miles City MT 59301

City Council

I am requesting permission to put in a 6 foot wide sidewalk at the curb, extending the full width of the front of my property. I would then like to put in a fence at the sidewalk with the sides connecting to the existing fence in my backyard.

Thank you for your consideration.

Sincerely

Shanna Abbott

A handwritten signature in cursive script that reads "Shanna Abbott". The signature is written in black ink and is positioned below the printed name.

6ft

Put in 6 foot sidewalk to curb

6ft

115 North

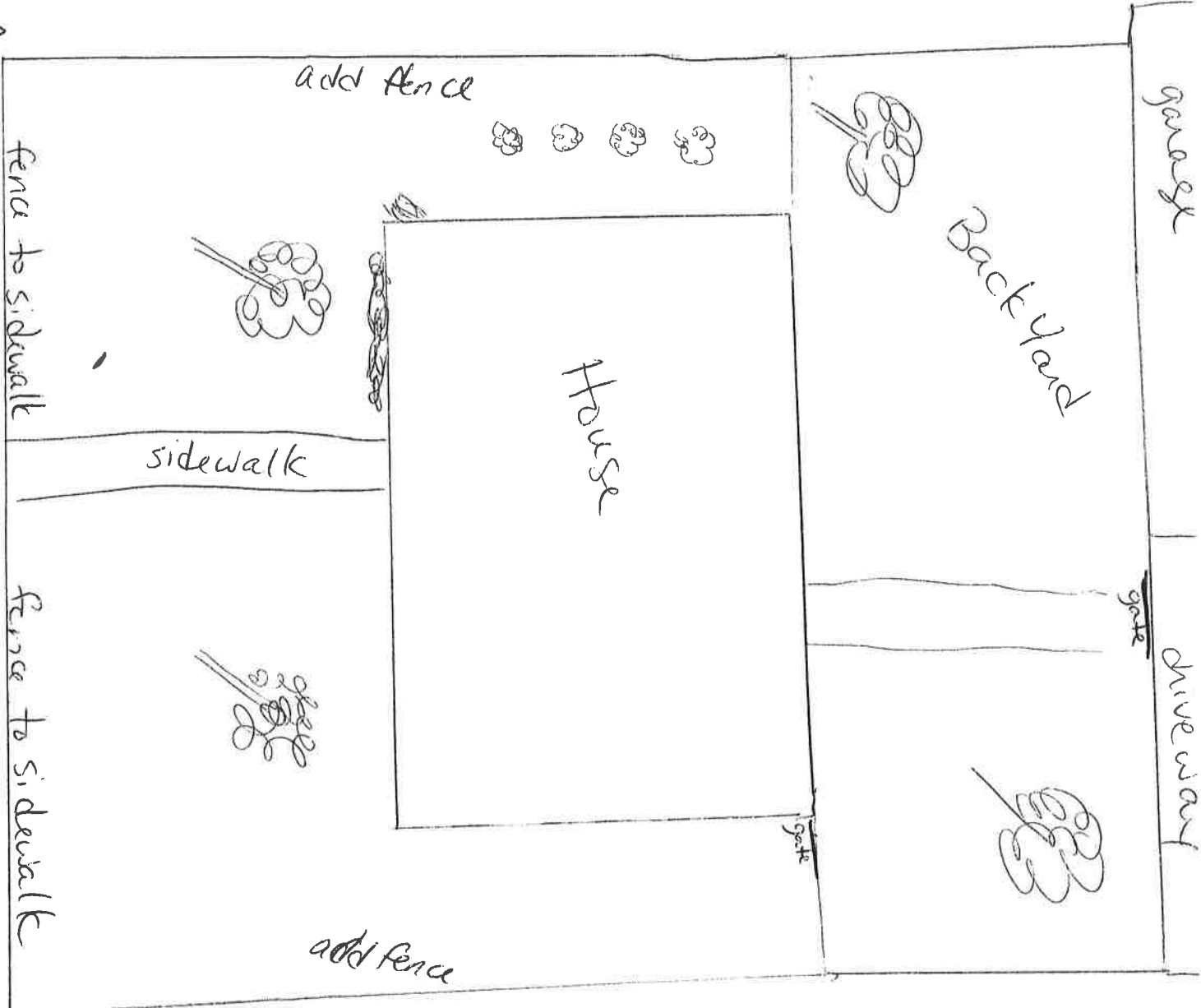

add fence

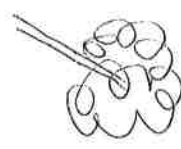

sidewalk

House

Back Yard

garage

gate

driveway

gate

add fence

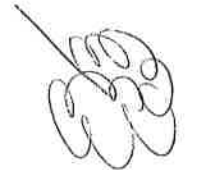



FENCES

Abbott

Solid wood fence ≥ 3'
Chain link fence ≥ 42"
for the first 25', then
can move up to 6'

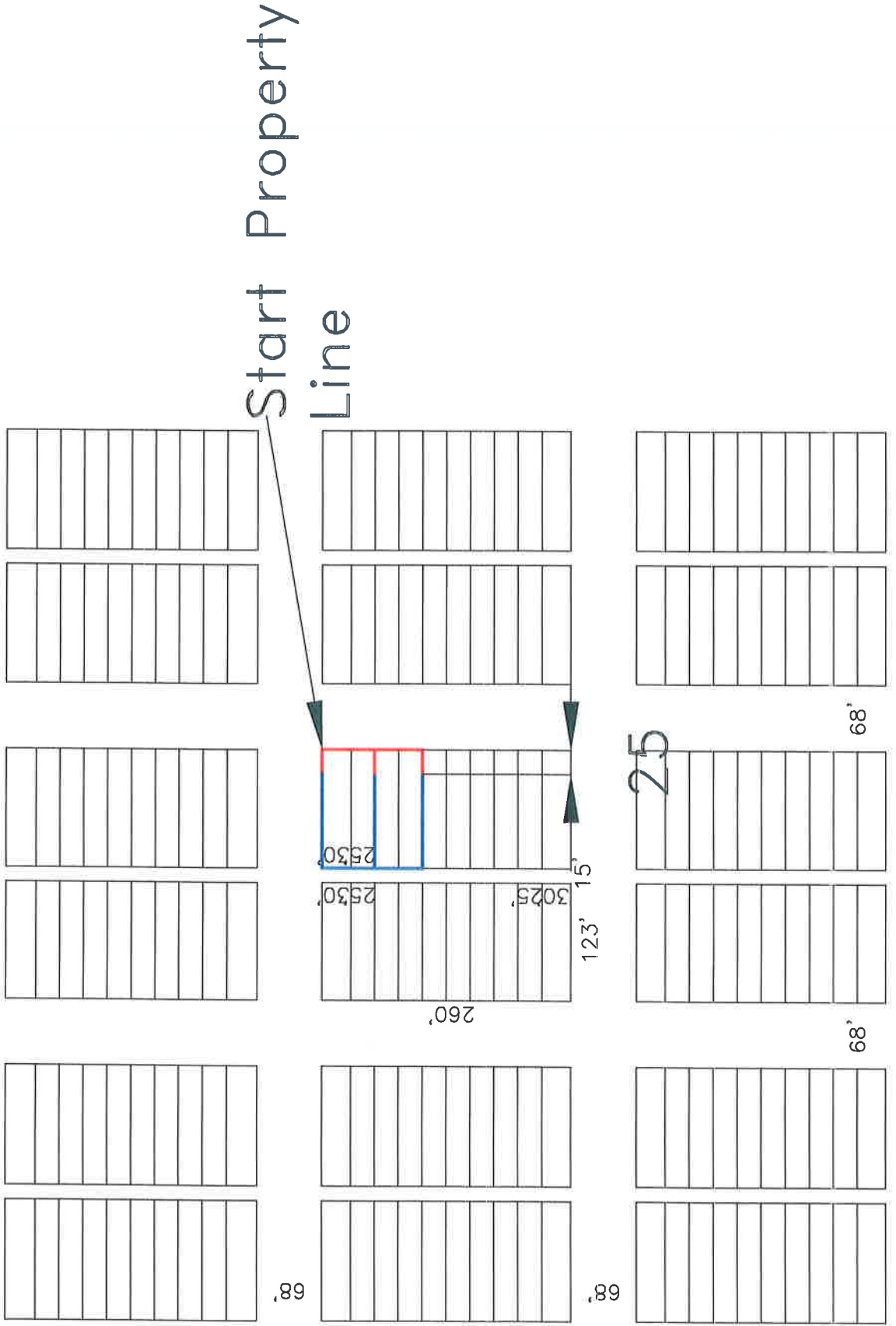

2	Montana Ave Sidewalks/Milwaukee RR Crossing	Suzanne / Duane	\$ 69,866	\$ 9,376	Ivy to Gordon & Lincoln to Bender Park	1541 ft	8.6 x 1541 x 6
---	---	-----------------	-----------	----------	--	---------	----------------

BUDGET

Item	Area	Cost	CTEP	City
Preliminary Engineering		\$ 12,455	\$ 10,783	\$ 1,447
	Design			
	ROW issues			
Construction Engineering		\$ 5,338	\$ 4,621	\$ 620
Construction		\$ -	\$ -	\$ -
	Mobilization @ 10%	\$ 3,235	\$ 2,801	\$ 376
	Concrete 365 ft * \$8.6 * 6ft	\$ 20,000	\$ 17,316	\$ 2,324
	Removal of old concrete	\$ 10,000	\$ 8,658	\$ 1,162
	Signs	\$ 1,400	\$ 1,212	\$ 163
	Pavement Markings	\$ 950	\$ 823	\$ 110
	Construction Total	\$ 35,585	\$ 30,809	\$ 4,135
		\$ 53,378	\$ 46,214	\$ 6,202

Gordon to Ivy

PRELIMINARY









